



2 BED TYPE 2C

Level 4-9

2 2 1

APT No.	INT. Area	EXT Area	Area Total
406, 506, 606, 706, 806, 906	74m ²	22m ²	96m ²

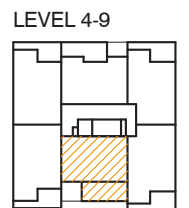

HARPERONHAMILTON.COM.AU

438-440 Hamilton Rd.
Chermside

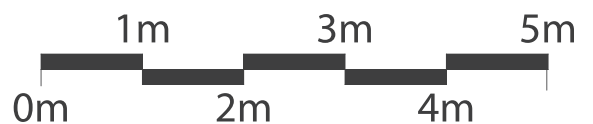

Whilst every care has been taken in the preparation of this document, it is for guidance only. The developer and its agents make no warranty or representation as to the accuracy, reliability, currency, or completeness of the information herein contained. Interested parties should satisfy themselves as to the accuracy, reliability, currency, or completeness of each description or reference. All information herein is subject to change without notice.



2 BED TYPE 3A

Level 4-9

2 2 1

APT No.	INT. Area	EXT Area	Area Total
402, 502, 602, 702, 802, 902	82m ²	17m ²	99m ²

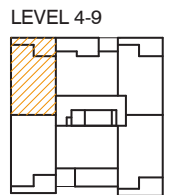

HARPERONHAMILTON.COM.AU

438-440 Hamilton Rd.
Chermside

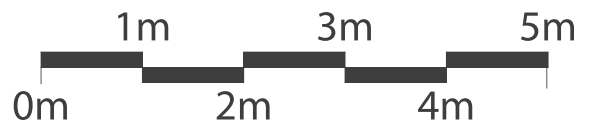

Whilst every care has been taken in the preparation of this document, it is for guidance only. The developer and its agents make no warranty or representation as to the accuracy, reliability, currency, or completeness of the information herein contained. Interested parties should satisfy themselves as to the accuracy, reliability, currency, or completeness of each description or reference. All information herein is subject to change without notice.



2 BED TYPE 4A

Level 4-9



APT No.	INT. Area	EXT Area	Area Total
404, 504, 604, 704, 804, 904	77m ²	17m ²	94m ²

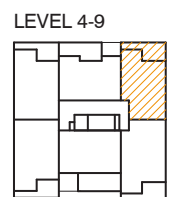

HARPERONHAMILTON.COM.AU

438-440 Hamilton Rd.
Chermside

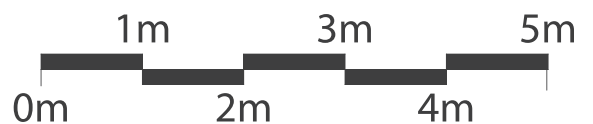

Whilst every care has been taken in the preparation of this document, it is for guidance only. The developer and its agents make no warranty or representation as to the accuracy, reliability, currency, or completeness of the information herein contained. Interested parties should satisfy themselves as to the accuracy, reliability, currency, or completeness of each description or reference. All information herein is subject to change without notice.



2 BED TYPE 2D

Level 4-9

2 2 1

APT No.	INT. Area	EXT Area	Area Total
503, 603, 703, 803, 903	74m ²	20m ²	94m ²



LEVEL 4-9

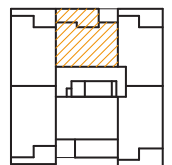

HARPERONHAMILTON.COM.AU

438-440 Hamilton Rd.
Chermside

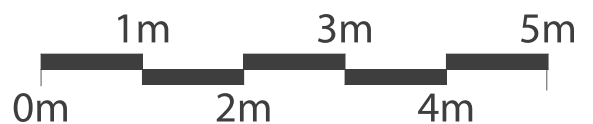

Whilst every care has been taken in the preparation of this document, it is for guidance only. The developer and its agents make no warranty or representation as to the accuracy, reliability, currency, or completeness of the information herein contained. Interested parties should satisfy themselves as to the accuracy, reliability, currency, or completeness of each description or reference. All information herein is subject to change without notice.



2 BED TYPE 2A

Level 2-3

2 2 1

APT No.	INT. Area	EXT Area	Area Total
204, 304, 403	74m ²	28m ²	102m ²

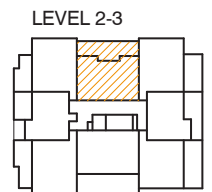

HARPERONHAMILTON.COM.AU

438-440 Hamilton Rd.
Chermside

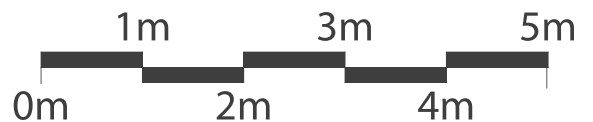

Whilst every care has been taken in the preparation of this document, it is for guidance only. The developer and its agents make no warranty or representation as to the accuracy, reliability, currency, or completeness of the information herein contained. Interested parties should satisfy themselves as to the accuracy, reliability, currency, or completeness of each description or reference. All information herein is subject to change without notice.